

vtech[®]

User's Manual

Pull & Learn Car Carrier™



© 2008 VTech
Printed in China
91-002289-000 (美)

Dear Parent,

Ever notice the look on your baby's face when they learn something new through their own discovery? These self-accomplished moments are a parent's greatest reward. To help fulfill them, **VTech**[®] created the **Infant Learning**[®] series of toys.

These unique interactive learning toys directly respond to what children do naturally – play! Using innovative technology, these toys react to baby's interactions, making each play experience fun and unique as they learn age-appropriate concepts like first words, numbers, shapes, colors and music. More importantly, **VTech**[®]'s **Infant Learning**[®] toys develop baby's mental and physical abilities by inspiring, engaging and teaching.

At **VTech**[®], we know that a child has the ability to do great things. That's why all of our electronic learning products are uniquely designed to develop a child's mind and allow them to learn to the best of their ability. We thank you for trusting **VTech**[®] with the important job of helping your child learn and grow!

Sincerely,

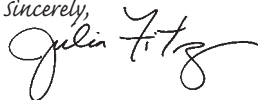

Julia Fitzgerald
Vice President, Marketing
Vtech Electronics, NA

To learn more about the **Infant Learning**[®] and other **VTech**[®] toys, visit www.vtechkids.com

INTRODUCTION

Thank you for purchasing the **VTech® Pull & Learn Car Carrier™** learning toy!

The **VTech® Pull & Learn Car Carrier™** is an electronic playset for toddlers 12 months and up. The car carrier is loaded with three vehicles and three animal characters for busy toddlers! Magical sensor on the back of the car carrier identifies the vehicles when they are roller over the sensor. Insert the animals into the hot spot to hear the related animal name and sound identified. A variety of play features and buttons teach age appropriate curriculum. Load up and let's go!

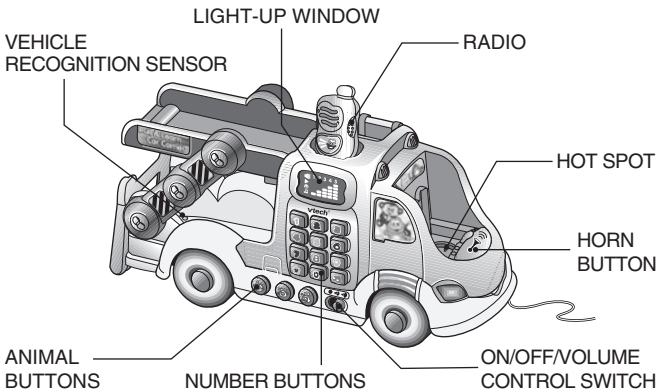

ANIMALS



VEHICLES

INCLUDED IN THIS PACKAGE

- One VTech® Pull & Learn Car Carrier™ learning toy
- One instruction manual
- 7 Smart Parts – Including 3 animals , 3 vehicles and 1 radio

Animals



Frog



Skunk



Bird

Vehicles



Car



Jeep



Tow Truck

Radio



WARNING: All packing materials, such as tape, plastic sheets, wire ties and tags are not part of this toy, and should be discarded for your child's safety.

BATTERY INSTALLATION

1. Make sure the unit is turned **OFF**.
2. Locate the battery cover on the bottom of the unit. Use a screwdriver to loosen the screw.
3. Install 2 new 'AA' (AM-3/LR6) batteries following the diagram inside the battery box.
4. Replace the battery cover and tighten the screw to secure.

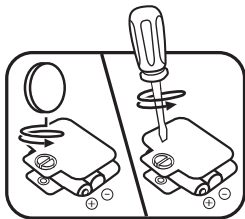

BATTERY NOTICE

- Install batteries correctly observing the polarity (+, -) signs to avoid leakage.
- Do not mix old and new batteries.
- Do not mix batteries of different types: alkaline, standard (carbon-zinc) or rechargeable (nickel-cadmium).
- Remove the batteries from the equipment when the unit will not be used for an extended period of time.
- Always remove exhausted batteries from the equipment.
- Do not dispose of batteries in fire.
- Do not attempt to recharge ordinary batteries.
- The supply terminals are not to be short-circuited.
- Only batteries of the same and equivalent type as recommended are to be used.

WE DO NOT RECOMMEND THE USE OF RECHARGEABLE BATTERIES.

PRODUCT FEATURES

1. ON/OFF/VOLUME CONTROL SWITCH

To turn the unit **ON**, slide the **ON/OFF/VOLUME CONTROL SWITCH** to the **LOW VOLUME** (🔊) or the **HIGH VOLUME** (🔊) position. To turn the unit **OFF**, slide the **ON/OFF/VOLUME CONTROL SWITCH** to the **OFF** (●) position.

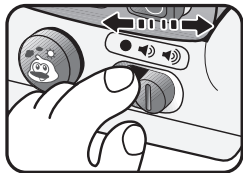

2. PULL CORD

To convert the unit from a push toy to a pull toy, remove the pull cord from the battery compartment and thread it through the eyelet on the bottom of the car carrier. For your child's safety, we suggest you store the pull cord in the compartment until your child is walking.

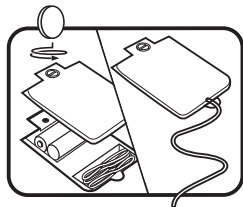

3. WHEELS

Before using the **VTech® Pull & Learn Car Carrier™**, please pull each wheel out to the outer groove position on the axle. Please check the wheels from time to time to ensure they haven't been pushed back to the inner position.

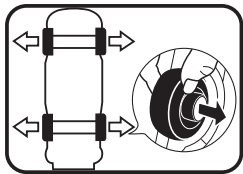

4. AUTOMATIC SHUT-OFF

To preserve battery life, the **VTech® Pull & Learn Car Carrier™** will automatically power-down after approximately 40 seconds without input. The unit can be turned on again by pressing any button.

ACTIVITIES

1. Slide the **on/off/volume control switch** to turn the unit on. You will hear a song and a welcoming phrase. The light will flash with the sound.

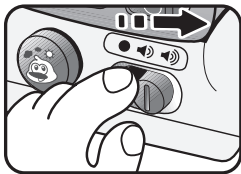

2. Press the **number buttons** to hear numbers, colors, short tunes and fun phrases. The light will flash with the sound.



3. Press the **animal buttons** to hear fun phrases, animal names and sounds and short tunes. The light will flash with sound.

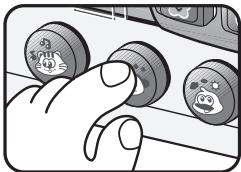

4. Press the **horn button** to hear playful driving phrases, sounds and a song. The light will flash with the sound.

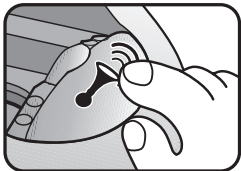

5. Pick up the **radio** or place it back on the car carrier to hear fun phrases and sounds. The light will flash with the sound.

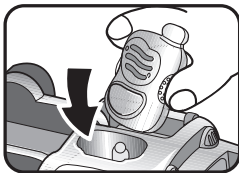

6. Push the **vehicles** over the sensor on the back of the car carrier to hear a variety of phrases, sounds and music. The light will flash with the sound.

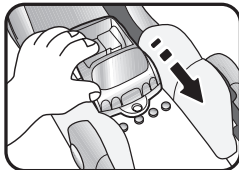

7. Place an **animal** into the hot spot to hear the animal name, a sound or a short phrase. Press on the animal while on the hot spot to hear a fun phrase or a random melody. Press the hot spot button to hear a random question. The light will flash with the sound.

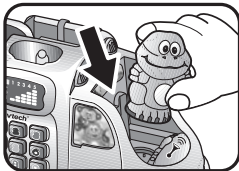

8. Fold out or fold up the **loading ramp** to hear playful phrases and sounds. The light will flash with the sound.

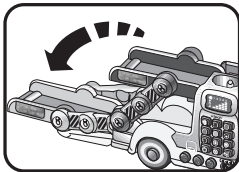

9. Push or pull the car carrier to hear a variety of vehicle sounds, phrases, songs and melodies. The light will flash with the sound.

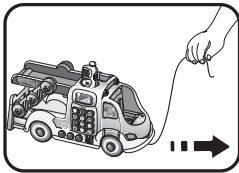

MELODY LIST

1. This Old Man
2. Oh! Susanna
3. She'll Be Comin' 'Round the Mountain
4. London Bridge
5. Aiken Drum
6. Sing a Song of Sixpence
7. Sur le pont d'Avignon
8. Hot Cross Buns

SONG LYRICS

SONG 1 (to the tune of "Ring Around the Rosy")

Drivin' down the highway,
Loaded up with cars.
Beep-Beep, Honk-Honk,
I'm on my way!

SONG 2 (to the tune of "Ring Around the Rosy")

Zip around the corner,
In my little tow truck.
Beep-beep! Watch out!
I'm on my way!

CARE & MAINTENANCE

1. Keep the unit clean by wiping it with a slightly damp cloth.
2. Keep the unit out of direct sunlight and away from any direct heat source.
3. Remove the batteries when the unit will not be in use for an extended period of time.
4. Do not drop the unit on hard surfaces and do not expose the unit to moisture or water.

TROUBLESHOOTING

If for some reason the program/activity stops working, please follow these steps:

1. Please turn the unit **OFF**.
2. Interrupt the power supply by removing the batteries.
3. Let the unit stand for a few minutes, then replace the batteries.
4. Turn the unit **ON**. The unit should now be ready to play again.
5. If the product still does not work, replace with a new set of batteries.

If the problem persists, please call our Consumer Services Department at 1-800-521-2010 in the U.S. or 1-877-352-8697 in Canada, and a service representative will be happy to help you.

For information on this product's warranty, please call **VTech®** at 1-800-521-2010 in the U.S. or 1-877-352-8697 in Canada.

IMPORTANT NOTE:

Creating and developing **Infant Learning** products is accompanied by a responsibility that we at **VTech®** take very seriously. We make every effort to ensure the accuracy of the information, which forms the value of our products. However, errors sometimes can occur. It is important for you to know that we stand behind our products and encourage you to call our Consumer Services Department at 1-800-521-2010 in the U.S. or 1-877-352-8697 in Canada, with any problems and/or suggestions that you might have. A service representative will be happy to help you.

Note:

This equipment has been tested and found to comply with the limits for a Class B digital device, pursuant to Part 15 of the FCC Rules. These limits are designed to provide reasonable protection against harmful interference in a residential installation. This equipment generates, uses and can radiate radio frequency energy and, if not installed and used in accordance with the instructions, may cause harmful interference to radio communications. However, there is no guarantee that interference will not occur in a particular installation. If this equipment does cause harmful interference to radio or television reception, which can be determined by turning the equipment off and on, the user is encouraged to try to correct the interference by one or more of the following measures:

- Reorient or relocate the receiving antenna
- Increase the separation between the equipment and receiver
- Connect the equipment into an outlet on a circuit different from that to which the receiver is connected
- Consult the dealer or an experienced radio/TV technician for help

This device complies with Part 15 of the FCC Rules. Operation is subject to the following two conditions: (1) this device may not cause harmful interference, and (2) this device must accept any interference received, including interference that may cause undesired operation.

This Class B digital apparatus complies with Canadian ices-003. Cet appareil numérique de la classe b est conforme à la norme nmb-003 du Canada.

Caution: changes or modifications not expressly approved by the party responsible for compliance could void the user's authority to operate the equipment.